



Rendered in Woodlands Palette



Rendered in Woodlands Palette



Rendered in Woodlands Palette



A PLAYCORE Company

www.gametime.com

Munster Parks and Recreation Cobblestone Park - Option Two



www.sinclair-rec.com



Rendered in Woodlands Palette

Munster Parks and Recreation Cobblestone Park - Option Two



Rendered in Woodlands Palette

Munster Parks and Recreation Cobblestone Park - Option Two



Rendered in Woodlands Palette



A PLAYCORE Company

www.gametime.com

Munster Parks and Recreation Cobblestone Park - Option Two



www.sinclair-rec.com



Rendered in Woodlands Palette



A PLAYCORE Company

www.gametime.com

Munster Parks and Recreation Cobblestone Park - Option Two



www.sinclair-rec.com

The proposed design encourages youth physical fitness through the six essential elements of play (swinging, spinning, sliding, climbing, balancing, and brachiating). Playground site is eligible to become a National Demonstration Site for PlayOn - designed following research from Playcore's Scholar Network - at no additional charge.

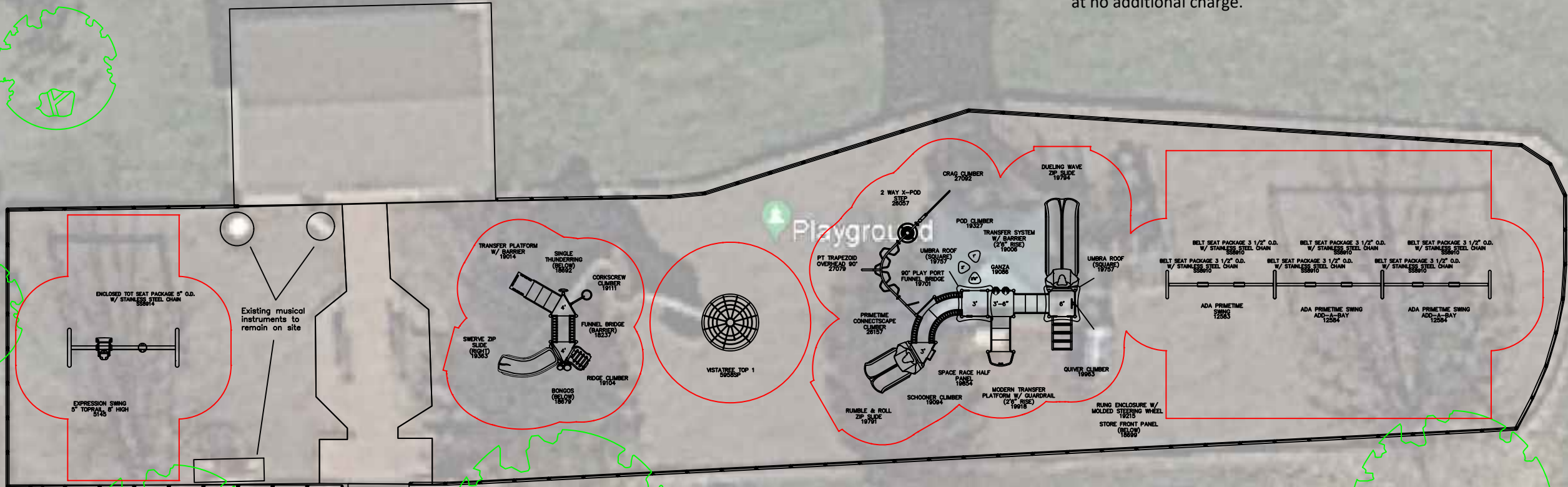

Existing playcurb edging to remain - new EWF to be added to area

Parking Lot



150 PlayCore Drive SE
Fort Payne, AL 35967
www.gametime.com

Munster Parks and Recreation
Cobblestone Park - Two
Munster, IN
Representative
Sinclair Recreation

63 ft

This Unit includes play events and routes or travel specifically designed for special needs users. It is the opinion of the manufacturer that these play events and routes of travel conform to the accessibility requirements of the ADA (Americans with Disabilities Act)

Total Elevated Play Components	14		0
Total Elevated Play Components Accessible By Ramp	0	Required	0
Total Elevated Components Accessible By Transfer	14	Required	7
Total Accessible Ground Level Components Shown	8	Required	3
Total Different Types Of Ground Level Components	7	Required	3

This play equipment is recommended for children ages 2-5 and 5-12

Minimum Area Required:
Existing
Scale: Bar
This drawing can be scaled only when in an 36" x 48" format

IMPORTANT: Soft resilient surfacing should be placed in the use zones of all equipment, as specified for each type of equipment, and at depths to meet the critical fall heights as specified by the U.S. consumer Product Safety Commission, ASTM standard F 1487 and Canadian Standard CAN/CSA-Z-614

Drawn By:
ALW
Date:
6/25/2024
Drawing Name:
Munster - Munster Parks and Rec



GameTime c/o Sinclair Recreation
 176 E Lakewood Blvd
 Holland, MI 49424
 Ph: 800-444-4954
 Fax: 616-392-8634

06/26/2024
 Quote #
 106359-01-02

Cobblestone Park - 2024 Playground Proposal - Option Two

Munster Parks & Recreation
 Attn: Mark Heintz
 1005 Ridge Road
 Munster, IN 46321
 UNITED STATES

Ship to Zip 46321

Quantity	Part #	Description	Unit Price	Amount
5825	EWf	GT-Impax - 12" compacted depth engineered wood fiber surfacing, blown in	\$3.70	\$21,552.50
1	INSTALL	GT-Impax - Removal and disposal of existing equipment- Rock wall climber, existing structure, two bay swings	\$13,500.00	\$13,500.00
1	INSTALL	GT-Impax - Installation of GameTime equipment into existing area- Does not include removal or disposal of existing playcurb edging, site restoration, or landscaping.	\$25,650.00	\$25,650.00
1	5958SP	GameTime - VistaTree Top 1	\$13,227.00	\$13,227.00
1	RDU	GameTime - PrimeTime unit for 2-5 year olds	\$17,671.00	\$17,671.00
		(6) 12025 -- 3 1/2" Uprt Ass'Y Alum 10'		
		(2) 18201 -- 36" Tri Punched Deck P/T		
		(1) 18679 -- Bongos		
		(1) 18692 -- Single Thunder Ring		
		(1) 19014 -- Transfer Platform W/ Barrier (4')		
		(1) 19104 -- Ridge Climber		
		(1) 19111 -- Corkscrew (3'-6" & 4')		
		(1) 19363 -- 3'-6"/4'-0" Zip Swerve Slide Right		
		(1) 18237 -- 3'-0" Funnel Bdg W/Barrier		
1	RDU	GameTime - Swings with Seats- Includes tot and expression swing to be installed on existing 5" swing frame	\$9,286.00	\$9,286.00
		(1) 5145 -- Expression Swing 5" X 8'		
		(1) 12583 -- Ada Primetime Swing Frame, 3 1/2" Od		
		(2) 12584 -- Ada Primetime Swing Aab, 3 1/2" Od		
		(6) SS8910 -- Belt Seat 3 1/2" /8' W/Clevis		
		(1) SS8914 -- Enclosed Tot 5"/8' High W/Clevis		
1	RDU	GameTime - Custom PrimeTime unit for 5-12 Year Olds	\$53,822.00	\$53,822.00
		(2) 12023 -- 3 1/2" Uprt Ass'Y Alum 8'		
		(5) 12024 -- 3 1/2" Uprt Ass'Y Alum 9'		
		(2) 12026 -- 3 1/2" Uprt Ass'Y Alum 11'		
		(1) 12027 -- 3 1/2" Uprt Ass'Y Alum 12'		
		(8) 12069 -- 3 1/2"Uprt Ass'Y Alum 14'		
		(3) 18200 -- 36" Sq Punched Deck P/T 1.3125		
		(1) 18201 -- 36" Tri Punched Deck P/T		





GameTime c/o Sinclair Recreation
 176 E Lakewood Blvd
 Holland, MI 49424
 Ph: 800-444-4954
 Fax: 616-392-8634

06/26/2024
 Quote #
 106359-01-02

Cobblestone Park - 2024 Playground Proposal - Option Two

Quantity	Part #	Description	Unit Price	Amount
		(1) 18699 -- Store Front Panel 36"		
		(4) 18832 -- Umbra Roof Extension 2'		
		(1) 19006 -- Transfer System W/Barrier (2'-6" Rise		
		(1) 19094 -- Schooner (2'-6" & 3')		
		(1) 19215 -- Rung Enclosure W/ Steering Wheel		
		(1) 19327 -- Pod Climber		
		(1) 19701 -- 90° Play Port Funnel Bridge		
		(2) 19757 -- Umbra Square Roof		
		(8) 19762 -- Umbra Roof Plug		
		(1) 19791 -- Dbl Rumble & Roll 2'-6"/3'		
		(1) 19794 -- Dueling Wave Zip 6'-0"		
		(1) 19854 -- Space Race Half Panel		
		(1) 19918 -- Modern Transfer w/Guard. 2'-6" Rise		
		(1) 19963 -- 6' Quiver Climber		
		(1) 26057 -- 2 Way X-Pod Step		
		(3) 26094 -- Triangular Shroud		
		(1) 26157 -- 3'-0" Connectscape Climber		
		(1) 27079 -- Trapezoid Overhead Ladder 90 Deg PT		
		(1) 27092 -- Crag Climber		
		(1) 19086 -- Ganza		
Contract: OMNIA #2017001134			Sub Total	\$154,708.50
			Discount	(\$35,763.84)
			Freight	\$6,028.25
			Total	\$124,972.91

This quotation is subject to policies in the current GameTime Playground Catalog and the following terms and conditions. Our quotation is based on shipment of all items at one time to a single destination, unless noted, and changes are subject to price adjustment. Purchases to be supported by your written purchase order made out to GAMETIME C/O SINCLAIR RECREATION. **A 2.5% PROCESSING FEE WILL BE ADDED TO ALL ORDERS PAID VIA CREDIT CARD.**

Pricing: f.o.b. factory, firm for 30 days from date of quotation unless otherwise noted on quotation. Sales tax will be added at time of invoicing unless a tax exemption certificate is provided at time of order entry.

Payment terms: Net 30 days for tax supported governmental agencies. A 1.5% per month finance charge will be imposed on all past due accounts. Equipment shall be invoiced separately from other services and shall be payable in advance of those services and project completion. Retainage not accepted.



GameTime c/o Sinclair Recreation
176 E Lakewood Blvd
Holland, MI 49424
Ph: 800-444-4954
Fax: 616-392-8634

06/26/2024
Quote #
106359-01-02

Cobblestone Park - 2024 Playground Proposal - Option Two

Shipment: Order shall ship within 6-8 weeks after GameTime's receipt and acceptance of your purchase order, color selections, approved submittals, and receipt of deposit, if required.

Installation: Shall be by a Certified GameTime Installer. Customer shall be responsible for scheduling coordination and site preparation. Site should be level and permit installation equipment access. Purchaser shall be responsible for unknown conditions such as buried utilities, tree stumps, bedrock or any concealed materials or conditions that may result in additional labor or material costs. Payment terms for installation is Net 10 Days.

NOTE: PRICING **DOES NOT** INCLUDE ANY DAVIS BACON OR PREVAILING WAGE RATES UNLESS SPECIFICALLY IDENTIFIED ABOVE IN QUOTE. THERE WILL BE A BACKCHARGE FOR THE INSTALLATION TO BE DONE THROUGH FELT, PEASTONE, SURFACING, OR WOODCHIPS, UNLESS SPECIFICALLY LISTED IN ABOVE QUOTE.

Exclusions: Unless specifically included, this quotation excludes all site work and landscaping; removal of existing equipment; acceptance of equipment and off-loading; storage of goods prior to installation; equipment assembly and installation; safety surfacing; borders, drainage provisions, or any local/municipal permits or paperwork that may be required.



GameTime c/o Sinclair Recreation
176 E Lakewood Blvd
Holland, MI 49424
Ph: 800-444-4954
Fax: 616-392-8634

06/26/2024
Quote #
106359-01-02

Cobblestone Park - 2024 Playground Proposal - Option Two

Acceptance of quotation:

Accepted By (printed): _____

Signature: _____

Title: _____

Facsimile: _____

Email: _____

P.O. No: _____

Please make P.O.s out to GameTime C/O Sinclair Recreation

Date: _____

Phone: _____

Purchase Amount: \$124,972.91

REQUIRED ORDER INFORMATION:

Bill To: _____

Contact: _____

Address: _____

Address: _____

City, State, Zip: _____

Tel: _____

(For Accounts Payable)

Email: _____

Ship To: _____

Contact: _____

Address: _____

Address: _____

City, State, Zip: _____

Tel: _____

(To call before delivery)

Email: _____

COLOR SELECTIONS: _____

SALES TAX EXEMPTION CERTIFICATE #: _____ (PLEASE PROVIDE A COPY OF CERTIFICATE)

NOTE: IF INSTALLATION IS BEING QUOTED, THERE WILL BE A BACKCHARGE FOR THE INSTALLATION TO BE DONE THROUGH FELT, PEASTONE, SURFACING, OR WOODCHIPS. PRICING VALID FOR 30 DAYS FROM THE DATE OF QUOTATION UNLESS OTHERWISE NOTED. ANY MODIFICATIONS TO AN ACCEPTED QUOTATION MUST BE DOCUMENTED IN WRITING OR WITH A NEW OR SEPARATE QUOTE. VERBAL MODIFICATIONS TO PREVIOUSLY SIGNED QUOTES WILL NOT BE ACCEPTED.